

PVC U CHANNEL PROFILES

PVC Rounded U channel

Convenient for foodsafe partitioning inside coldrooms

- The edge detail of the 'U' channel allows easy panel insertion.
- The joint to be finished with a sealant if this is required.

Full compatibility with Plinth Profiles EX.15 and EX.80

- The U channels have a rounded edge profile for an optimized hygienic cleaning.
- In case of "high level" hygienic cleaning requirements, EX.15 or EX.80 plinths can be aesthetically added.

- Standard white colours (STDW)

CI902	CW903	CW910
-------	-------	-------

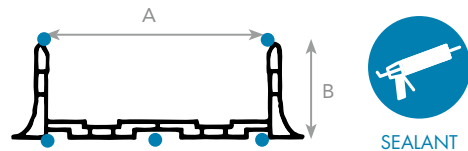

Model	EX.04	EX.49	EX.05	EX.06	EX.23
Part Code	0607.00001.xxx	0607.00002.xxx	0607.00003.xxx	0607.00004.xxx	0607.00005.xxx
Size A	60 mm	75 mm	80 mm	100 mm	120 mm
Size B	45 mm	45 mm	45 mm	45 mm	45 mm
Length	3 M	3 M	3 M	3 M	3 M
Packing - MOQ - OI	120 M	(1620 M)	135 M	126 M	(1612 M)
Multi-packing	(540 M)	(1620 M)	(540 M)	(504 M)	(1612 M)
Availability	standard	on request (*)	standard	standard	on request (*)

PVC 90° Connection corner profile for rounded U channel

- Standard white colours (STDW)

CI902	CW910
-------	-------

Model	INJ.81	INJ.248
Part Code	0607.00006.xxx	0607.00008.xxx
Compatible with	EX.04	EX.05
Size	150 x 150 x 60 mm for EX.04	150 x 150 x 80 mm for EX.05
Packing - MOQ - OI	84 pcs/ box	72 pcs/ box
Availability	standard	standard



PVC End cap for rounded U channel

- Standard white colours (STDW)

CI902	CW903	CW910
-------	-------	-------

Model	INJ.49
Part Code	0607.00009.xxx
Compatible with	EX.04 • EX.49 • EX.05 • EX.04 • EX.23
Packing - MOQ - OI	50 pcs (=5 x (5L + 5R))
Availability	standard



Perfiles sanitarios

Sanitary profiles

Perfiles en U para fijación paneles frigoríficos al suelo en P.V.C. rígido con borde curvado
 Color: RAL 9002
 Largo standard: 3 m

Cod. FI02811
 Ref. 294-6

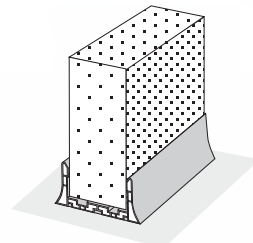
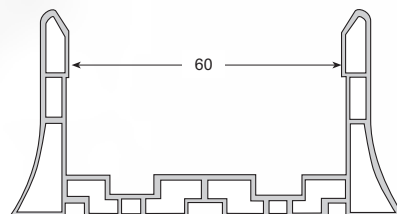

Rigid P.V.C. U for the fastening of insulated panels to the floor, with rounded corners
 Colour: RAL 9002
 Standard length: 3 m.

Cod. FI02955
 Ref. 294-7

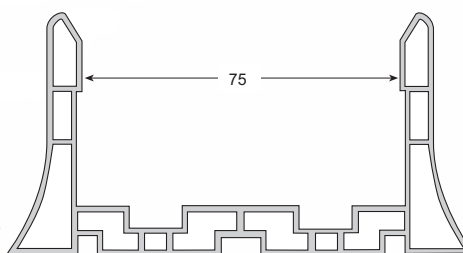

Cod. FI02812
 Ref. 294-8

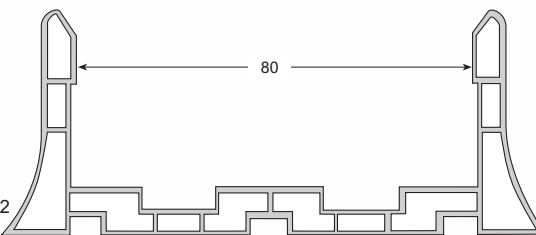

Cod. FI02813
 Ref. 294-10

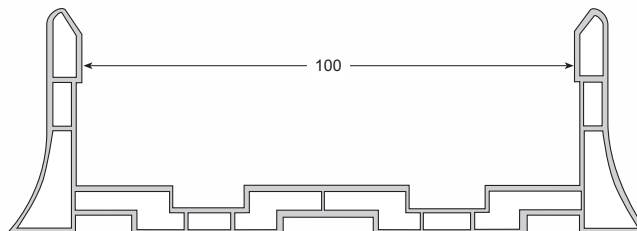

Cod. FI02814
 Ref. 294-12

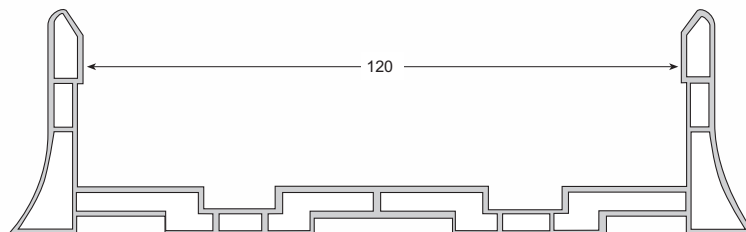

Tapa lateral perfil en U fijación paneles
 Color: RAL 9002

End cap for the U profile
 Colour: RAL 9002

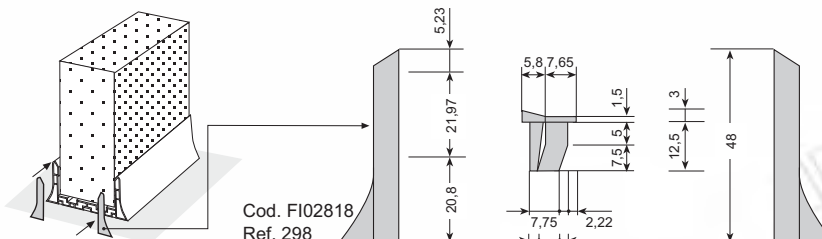

Cod. FI02818
 Ref. 298